

Im Hofstätt 11
D- 72359 Dotternhausen
Phone +49 (0)7427 9480-0
Fax +49 (0)7427 9480-7025
E-Mail info@proactiv-gmbh.de
www.proactiv-gmbh.com



Quotation date: _____

Order date: _____

according to GTC PRO ACTIV GmbH

Medical suppliers/company address:

Cust. no.: _____
Name: _____
Street: _____
Postcode, city: _____
Phone: _____
Fax: _____
E-Mail: _____
Contact: _____

Invoicing address, other (see below)

Cust. no.: _____
Name: _____
Street: _____
Postcode, city: _____

Shipping address, other (see below)

Cust. no.: _____
Name: _____
Street: _____
Postcode, city: _____

Customer name/commission:

Name: _____
Street: _____
Postcode, city: _____
Phone: _____
Fax: _____
E-Mail: _____
DoB: _____
Paying organisation: _____
Indication: _____

NJ1 Compact bike

with hub gear and back pedal brake

Maximum user weight limit 100 kg

- girder chassis with reinforcing brace
- drive unit, can be decoupled via the eccentric quick-lock system
- A-shaped handles with integrated switching and brake fittings
- infinitely adjustable backrest
- 6° wheel camber
- back pedal brake integrated in the hub gear
- Shimano V-brake (rim brake) incl. locking mechanism
- safety flag

9100101000 € 3,390.00

Services:

Delivery, instruction and handing over at the customer by PRO ACTIV

9990000003 € 425.00

plus shipping costs

Body size

Body height: _____ cm

Weight: _____ kg

Chassis colour

Information on current colour designs and example images under:
www.proactiv-gmbh.de/farben.php

White RAL 9016

- gloss 9000100170-023
- matt 9000100170-123 **€ 33.30**

Brilliant silver

- gloss 9000100170-011

Anthracite RAL 7016

- gloss 9000100170-001
- matt 9000100170-101 **€ 33.30**

Black RAL 9005

- gloss 9000100170-003
- matt 9000100170-019 **€ 33.30**

Deep black, silver effect

- gloss 9000100170-007

Pure orange RAL 2004

- gloss 9000100170-022

Fire Red

- gloss 9000100170-018
- matt 9000100170-118 **€ 33.30**

Pink magenta RAL 4010

- gloss 9000100170-037
- matt 9000100170-137 **€ 33.30**

Sky blue

- gloss 9000100170-017

Pastel blue RAL 5024

- gloss 9000100170-036
- matt 9000100170-136 **€ 33.30**

Marine blue

- gloss 9000100170-045
- matt 9000100170-145 **€ 33.30**

Apple green

- gloss 9000100170-014
- matt 9000100170-114 **€ 33.30**

Lemon green

- gloss 9000100170-005
- matt 9000100170-105 **€ 33.30**

Violet

- gloss 9000100170-044

Yellow RAL 1023

- gloss 9000100170-046
- matt 9000100170-146 **€ 33.30**

Red RAL 3001

- gloss 9000100170-047
- matt 9000100170-147 **€ 33.30**

Powder coating, transparent

- gloss 9000100170-029

Black Shadow, deep black drive unit RAL 9005, smooth gloss

- 9110100170-001 **€ 103.80**

- fork tube R and L
- fork bridge, top and bottom
- bottom bracket support

Hub drive system

Shimano "Nexus" 7-speed hub gear

- 9100200022
- "Grip Shift" twist grip shifter
- Gear ratio: Sprocket 32 teeth,
Cassette 20 teeth
- (with bottom bracket support L – 19 teeth)



Shimano "Nexus" 8-speed hub gear

- 9100200023 **€ 138.50**
- "Grip Shift" twist grip shifter
- Gear ratio: Sprocket 32 teeth,
Cassette 20 teeth
- (with bottom bracket support L – 19 teeth)



Gear change accessories

Mountain drive 2.5: 1 gear reduction for hills in combination with hub gear

- 9100200003 **€ 499.80**
- Planetary gear set for doubling of the number of
gears
- All gears (the hub gear and the gear reduction
for hills) can be changed when stationary.
- In combination with grip width 40 or 45 cm!



Chassis

Chassis geometry

- Length 104 cm
Seat width
approx. 39 cm
9100100000-001
- Length 116 cm
Seat width
approx. 39 cm
9100100000-002
- Length 116 cm **€ 161.20**
Seat width
approx. 43 cm
9100100000-003
- Heavy Duty version **€ 335.50**
up to 120 kg body weight
9100800013

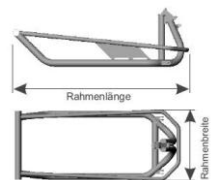

Drive unit colour

Silver, anodised drive unit

- 9110100170-000

Dimensions

Pedal bearing shaft

- Grip width 40 cm
9100500100-040
- Grip width 45 cm
9100500100-045
- Grip width 50 cm
9100500100-050



Fixed bottom bracket support

- XS (X/Y 113/130)
9100501100-004
- S (X/Y 67/153)
9100501100-003
- M (X/Y 90/250)
9100501100-001

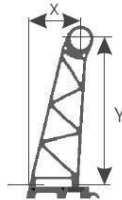

Adjustable bottom bracket support

- 9100500001 **€ 182.90**

Adjustable angle via clamped hinge on the fork bridge and in their length.

For the pre-setting, please specify the bottom bracket support size that comes as close to your desired position.



Size: _____

If not specified, the adjustable bottom bracket support size S will be delivered.



Pedal crank

- Length 155 mm
9100600100-155
- Length 175 mm
9100600100-175
- Length 195 mm
9100600100-195



Customer-specific crank length according to dimension

_____ mm (minimum length 125 mm)

- 9100600101 **€ 155.80**

Leg rest

Leg rest separated

- 9100100008
Adaptation on the fork for short legs
Only possible up to body size 165 cm!



Leg rest wrapping

- 9100100009
Adaptation on the fork



Leg rest adapted to the chassis

- 9100100010 **€ 400.40**

Legs not influenced by steering movement.
Increases the vehicle width!
Not in combination with the leg shield.



Foot stopper for leg rest

- 9100100012 **€ 71.90**



Thigh anchorage

- 9100100013 **€ 127.90**



Back equipment

Backrest with filler and 1.5 cm foam padding

- 9100800000



Body contour back padding

- 9100800010 **€ 123.80**

with back padding 3 cm
Cover: black/breathable



Seat upholstery

Open belt system seat upholstery

- 9100801010



Body contour seat upholstery

- 9100801025
breathable, cushioning effect



Seat cushion

shape dimensions in cm	seat cushion "Standard" 9100000190	seat cushion with upper leg guidance 9100800103
	Chassis: 104 SB: 39 ST: 30	-001 <input type="checkbox"/>
Chassis: 116 SB: 39 ST: 40	-002 <input type="checkbox"/>	-002 <input type="checkbox"/>
Chassis: 116 SB: 43 ST: 40	-003 <input type="checkbox"/>	-003 <input type="checkbox"/>
price	€ 88,30	€ 161,10

Cover: black, breathable, open fabric surface
height: 4cm

seat cushion with upper leg guidance only in combination with hip safety belt.

Wheels

Running wheels with double-wall rim

- 26" (559)
9100104260

Tyres

Schwalbe "Durano"

- 26x1.1" (559-28)
9100105000

Racing-Slic

Schwalbe Marathon Plus Tour

- 26x2,0" (559-50) € 58.80
9100105140



Bracket ø 22 mm x 42 mm for fixing of accessories (speedometer, lighting, or similar)

- 9110903271 **Item price € 18.30**

Colour: natural anodised

_____ Items



Lighting set SIGMA Lightster LED with bracket

- 9100900019 € 102.50

with battery charger and set of batteries (4 pcs. NICD) front and rear lights



Options for users with reduced function

Tetra hand support, pivotable, adjustable grip distance

- 9110601101 € 140.30



Tetra shell handles

- 9110601100 € 135.90



Tetra backhand support

- 9110601102 € 158.60

pivotable, adjustable distance to the bike handle



Bike accessories

Plug-in protection plate

- 9110502100 € 45.80



Leg guard

- 9100100231 € 141.50

Guard for MTB tyres
Screwed onto the fork tube
Colour: black matt

Collision guard clamped on the axle tube

- 9100800100 € 171.80

with 40 mm mounting clip



Neck rest

- 9100800150 € 206.00

height-adjustable
angle-adjustable



Hip safety belt

- 9100800200 € 93.50



SIGMA BC 1200 Bike Computer

- 9110901000 € 55.30

wireless
with bracket



SIGMA BC 1606L DTS Bike Computer

- 9110900018 € 135.20

with pedal frequency set
wireless



Your additional notes:

I herewith confirm the details listed above

Location, Date

Signature (End customer)

Location, Date

Signature (Dealer)